

Mini Compact Valves SCPM EV



Suitability for Industry Specific Applications



Applications

- Application in vacuum systems for controlling the gripping and depositing of workpieces
- Use in combination with central electrical vacuum generators
- Use in combination with (compact) ejectors
- Compact design enables use in systems with confined space conditions

Mini Compact Valves SCPM EV

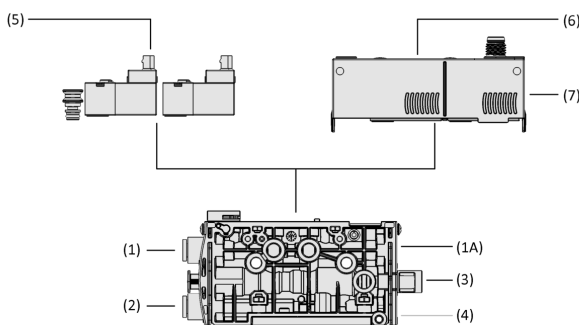

Design

- Minimal footprint thanks to compact main body made from high-strength plastics with individual control module (7)
- 3-digit display with two-button operation and electrical connection M8, 6-pin plug (6)
- Pneumatic valves optionally integrated (6) or directly mounted (5) for switching function NO or NC
- Screw for adjusting blow off function (4)
- Compressed air connection (1) for pilot control and vacuum connection (2)
- Connection for external vacuum supply "EV" (1A)

System Design Mini Compact Valves SCPM EV

Product Highlights

- Valve with automatic internal blow off for reduced wiring effort
- Integrated valve and sensor functionalities for fast start of operations
- Intelligent valves for monitoring evacuation time and leakage in vacuum systems

Mini Compact Valves SCPM EV

Ordering Data Mini Compact Valves SCPM EV

Type	Part no.
SCPMb EV S09 NC A13	10.02.02.06219
SCPMb EV S09 NO A16	10.02.02.06220
SCPMc EV S09 NC M8-6 PNP ABA	10.02.02.06211
SCPMc EV S09 NC M8-6 NPN BTU	10.02.02.06221
SCPMc EV S09 NO M8-6 PNP ABB	10.02.02.06217
SCPMc EV S09 NO M8-6 NPN BT1	10.02.02.06222
SCPMi EV S09 NC M8-6 ABO	10.02.02.06218
SCPMi EV S09 NO M8-6 B3R	10.02.02.06223

Ordering Data Accessories Mini Compact Valves SCPM EV

Accessories		Part no.
Connection cable	ASK WB-M8-6 2000 K-6P	21.04.05.00488
Connection cable	ASK WB-M8-6 2000 S-M12-5	21.04.05.00489
Connection cable	ASK B-M8-6 5000 K-6P	21.04.05.00255
Distributor	ASV SCPMi B-M8-6 2xS-M12-4	10.02.02.05602
Mounting set	SET SCPM MOUNT1	10.02.02.05805
Exhaust air set	ABL-SET SCPMi/c/b	10.02.02.06080
Plug union, straight	STV-GE M5-AG 4	10.08.02.00468
Plug union, straight	STV-GE M7-AG 6	10.08.02.00469
Mounting bracket	BEF-WIN 15x50x36.1 1.5 SCPM	10.02.02.05824
Thread adapter (inst)	ADP-G M5-IG 10.8x6 SCPMi/c/b	10.02.02.05778
Thread adapter (inst)	ADP-G M7-IG 10.8x7.9 SCPMi/c/b	10.02.02.05522

Technical Data Mini Compact Valves SCPM EV

Type	Type	Control valve	Electrical connection	Connection	Suction rate (max.) [l/min]	Max. air consumption blow off [l/min]	Optimal operating pressure [bar]	Operating pressure	Operating temperature	Weight [g]
SCPMb EV S09 NC A13	-	Normally closed	-	Hose D6(1A)-D4(1)-D6(2)	33	10	4.5	4.0 ... 6.0 bar	0 ... 50 °C	75
SCPMb EV S09 NO A16	-	Normally open	-	Hose D6(1A)-D4(1)-D6(2)	33	10	4.5	4.0 ... 6.0 bar	0 ... 50 °C	75
SCPMc EV S09 NC M8-6 PNP ABA	PNP switching	Normally closed	Male connect M8, 6 pole	Hose D6(1A)-D4(1)-D6(2)	33	10	4.5	4.0 ... 6.0 bar	0 ... 50 °C	87
SCPMc EV S09 NC M8-6 NPN BTU	NPN switching	Normally closed	Male connect M8, 6 pole	Hose D6(1A)-D4(1)-D6(2)	33	10	4.5	4.0 ... 6.0 bar	0 ... 50 °C	87
SCPMc EV S09 NO M8-6 PNP ABB	PNP switching	Normally open	Male connect M8, 6 pole	Hose D6(1A)-D4(1)-D6(2)	33	10	4.5	4.0 ... 6.0 bar	0 ... 50 °C	87
SCPMc EV S09 NO M8-6 NPN BT1	NPN switching	Normally open	Male connect M8, 6 pole	Hose D6(1A)-D4(1)-D6(2)	33	10	4.5	4.0 ... 6.0 bar	0 ... 50 °C	87
SCPMi EV S09 NC M8-6 ABO	-	Normally closed	Male connect M8, 6 pole	Hose D6(1A)-D4(1)-D6(2)	33	10	4.5	4.0 ... 6.0 bar	0 ... 50 °C	87
SCPMi EV S09 NO M8-6 B3R	-	Normally open	Male connect M8, 6 pole	Hose D6(1A)-D4(1)-D6(2)	33	10	4.5	4.0 ... 6.0 bar	0 ... 50 °C	87

Mini Compact Valves SCPM EV

Design Data Mini Compact Valves SCPM EV

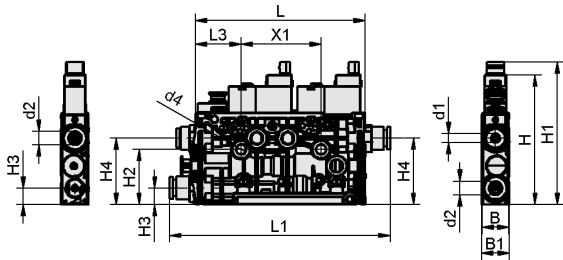

SCPMb EV

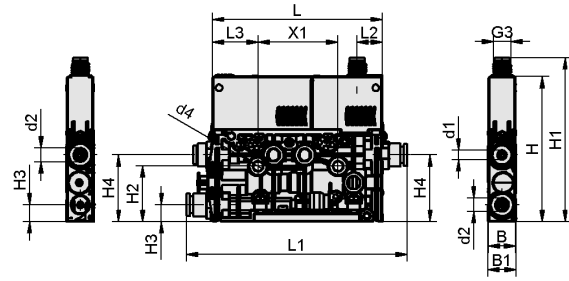

SCPMc EV, SCPMi EV

Mini Compact Valves SCPM EV

Design Data Mini Compact Valves SCPM EV

Type	B [mm]	B1 [mm]	d1 [mm]	d2 [mm]	d4 [mm]	G3	L [mm]	L1 [mm]	L2 [mm]	L3 [mm]	H [mm]	H1 [mm]	H2 [mm]	H3 [mm]	H4 [mm]	X1 [mm]
SCPMb	12	12.5	4.2	6.2	4.3	-	76.5	99.5	-	20.5	58.5	64.50	25.00	7.5	30	36
SCPMc	12	12.5	4.2	6.2	4.3	M8x1-M	76.5	99.4	11.4	20.5	65.3	73.91	24.95	7.5	30	36
SCPMi	12	12.5	4.2	6.2	4.3	M8x1-M	76.5	99.5	11.4	20.5	65.5	73.80	25.00	7.5	30	36