

Bulkhead Connectors SVS-GE

Suction cup connection G1/8" and G1/4"

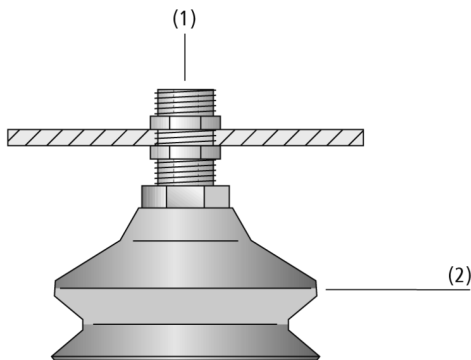

Bulkhead Connectors SVS-GE



System design Bulkhead Connectors SVS-GE



Mounting example bulkhead connectors SVS-GE

Suitability for industry specific applications

Application

- Bulkhead connector for mounting of suction cups
- Adaptation of push-in fittings for the hose connection

Design

- Stainless steel sleeve with male and female threads
- Two locking (galvanized) nuts included
- Flats for spanner on male thread
- Vacuum connection (1) by plug-in union (not included in delivery), see chapter "Filters and Connections"
- Suitable suction cups (2) can be found in section "Vacuum Suction Cups"

Product highlights

- All suction cups and nipples with G1/8"-AG and G1/4"-AG threads can be screwed in
- Male thread over the entire height enables fine adjustment when installing the suction cup
- Required lock nuts included in the scope of delivery
- Stable and rustproof thanks to stainless steel

Bulkhead Connectors SVS-GE

Suction cup connection G1/8" and G1/4"

Designation code Bulkhead Connectors SVS-GE

| | | | | | | |
|--------|---|----------|---|---------|---|----|
| SVS-GE | – | M16x1-AG | – | G1/8-IG | – | 30 |
| 1 | | 2 | | 3 | | 4 |

1 – Abbreviated designation

| Code | Version |
|--------|---------|
| SVS-GE | SVS-GE |

2 – Male thread

| Code | Thread |
|------------|--------------------------|
| M16x1-AG | M16x1-AG (AG = male (M)) |
| M20x1.5-AG | M20x1.5-AG |

3 – Connection

| Code | Connection |
|---------|---------------------------|
| G1/8-IG | G1/8-IG (IG = female (F)) |
| G1/4-IG | G1/4-IG |

4 – Length

| Code | Length in mm |
|------|--------------|
| 30 | 30 |

Bulkhead connector SVS-GE is delivered as a ready-to-connect product, including two locking nuts.

Ordering data Bulkhead Connectors SVS-GE

| Type | Part no. |
|------------------------------|----------------|
| SVS-GE M16x1-AG G1/8-IG 30 | 10.08.03.00181 |
| SVS-GE M20x1.5-AG G1/4-IG 30 | 10.08.03.00180 |

Bulkhead Connectors SVS-GE

Suction cup connection G1/8" and G1/4"

Design data Bulkhead Connectors SVS-GE

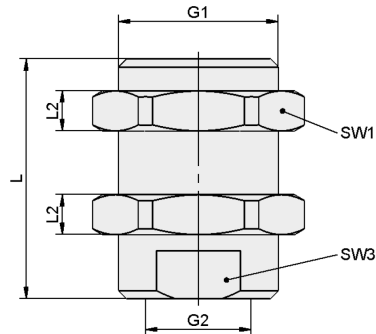

SVS-GE

Bulkhead Connectors SVS-GE

Suction cup connection G1/8" and G1/4"

Design data Bulkhead Connectors SVS-GE

| Type | G1 | G2 | L [mm] | L2 [mm] | SW1 [mm] | SW3 [mm] |
|------------------------------|-----------|---------|--------|---------|----------|----------|
| SVS-GE M16x1-AG G1/8-IG 30 | M16x1-M | G1/8"-F | 30 | 5 | 22 | 13 |
| SVS-GE M20x1.5-AG G1/4-IG 30 | M20x1.5-M | G1/4"-F | 30 | 5 | 24 | 17 |