

Solenoid Valves EMVO

Nominal diameter from 12 mm to 25 mm



Suitability for Industry Specific Applications



Applications

- Solenoid valve for use at high volume flow rates in systems with large cross sections
- Control of vacuum and venting of the suction cup
- Suitable for neutral or filtered air

Solenoid Valves EMVO

Design

- Directly controlled solenoid valve
- Switching function (NC)
- Seat valve in housing made of brass and aluminum
- Degree of protection IP 65
- Connection socket complies with DIN 43 650, Form A
- Supplied complete with plug connector

Product Highlights

- 3/2 multiway valve for controlling vacuum on/off or ventilation
- Valve suitable for large nominal flows
- Direct control enables fastest opening and closing times

Designation Code Solenoid Valves EMVO

EMVO	-	12	-	230V-AC	-	3/2	-	NC
1		2		3		4		5

1 – Abbreviated designation

Code	Version
EMVO	EMVO

2 – Nozzle size

Code	Nozzle size in mm
12...25	12 to 25

3 – Voltage

Code	Voltage in V
24V-DC	Direct current
230V-AC	Single phase

4 – Variant

Code	Type
3/2	3/2-way valve

5 – Idle position suction valve

Code	Type
NC	Normally closed
NO	Normally open

Solenoid valve EMVO is delivered as a ready-to-connect product.

Available accessories: venting filter

Solenoid Valves EMVO

Nominal diameter from 12 mm to 25 mm

Ordering Data Solenoid Valves EMVO

Type	Part no.
EMVO 12 230V-AC 3/2 NC	10.05.01.00052
EMVO 12 24V-DC 3/2 NC	10.05.01.00049
EMVO 20 230V-AC 3/2 NC	10.05.01.00053
EMVO 20 24V-DC 3/2 NC	10.05.01.00050
EMVO 25 24V-DC 3/2 NC	10.05.01.00051

Ordering Data Accessories Solenoid Valves EMVO

Type	Accessories	Part no.
EMVO 12 230V-AC 3/2 NC	Venting filter FAS 80x33.8 G1/2-AG	10.05.01.00061
EMVO 12 24V-DC 3/2 NC	Venting filter FAS 80x33.8 G1/2-AG	10.05.01.00061
EMVO 20 230V-AC 3/2 NC	Venting filter FAS 80x39 G3/4-AG	10.05.01.00062
EMVO 20 24V-DC 3/2 NC	Venting filter FAS 80x39 G3/4-AG	10.05.01.00062
EMVO 25 24V-DC 3/2 NC	Venting filter FAS 80x38 G1-AG EMVP	10.05.01.00063

Technical Data Solenoid Valves EMVO

Type	Control valve	Nominal flow rate [m³/h]	Nominal flow rate [l/min]	Power consumption DC [W]	Power consumption AC [W]	Weight [kg]
EMVO 12 230V-AC 3/2 NC	Normally closed	21	350	-	39.1	1.2
EMVO 12 24V-DC 3/2 NC	Normally closed	21	350	31.9	-	1.2
EMVO 20 230V-AC 3/2 NC	Normally closed	72	1,200	-	36.8	5.8
EMVO 20 24V-DC 3/2 NC	Normally closed	72	1,200	40.8	-	5.8
EMVO 25 24V-DC 3/2 NC	Normally closed	101	1,684	40.8	-	5.7

Solenoid Valves EMVO

Nominal diameter from 12 mm to 25 mm

Design Data Solenoid Valves EMVO

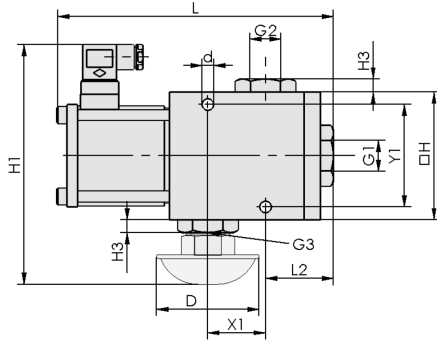

EMVO

Solenoid Valves EMVO

Nominal diameter from 12 mm to 25 mm

Design Data Solenoid Valves EMVO

Type	d [mm]	D [mm]	G1	G2	G3	H [mm]	H1 [mm]	H3 [mm]	L [mm]	L2 [mm]	X1 [mm]	Y1 [mm]
EMVO 12 230V-AC 3/2 NC	6.5	80	G1/2"-F	G1/2"-F	G1/2"-F	60	135.5	-	122	32	24	40
EMVO 12 24V-DC 3/2 NC	6.5	80	G1/2"-F	G1/2"-F	G1/2"-F	60	135.5	-	122	32	24	40
EMVO 20 230V-AC 3/2 NC	9.0	80	G3/4"-F	G3/4"-F	G3/4"-F	100	187.5	10	206	43	45	80
EMVO 20 24V-DC 3/2 NC	9.0	80	G3/4"-F	G3/4"-F	G3/4"-F	100	187.5	10	206	43	45	80
EMVO 25 24V-DC 3/2 NC	9.0	80	G1"-F	G1"-F	G1"-F	100	172.0	-	206	43	45	80