

技術資料 Technische Documentatie **Documentation**  
Documentação técnica Documentación técnica Documentazione tecnica  
**Technische Dokumentation** Technical Documentation Техническая документация  
Documentazione tecnica Technische documentatie  
Техническая документация **Teknik Doküman** 技术资料  
**Documentazione tecnica** Dokumentacja techniczna  
**Technische documentatie** Documentación técnica 技術資料  
기술 자료 Technische documentatie 技術資料  
Documentation technique Teknik Doküman Dokumentacja techniczna  
Technical Documentation **Documentazione tecnica** Technical Documentation  
**Dokumentacja techniczna** 技术资料 Documentation technique  
Техническая документация Technische Dokumentation **Teknik Doküman**  
Dokumentacja techniczna Technische documentatie  
Documentation technique 기술 자료 Dokumentacja techniczna

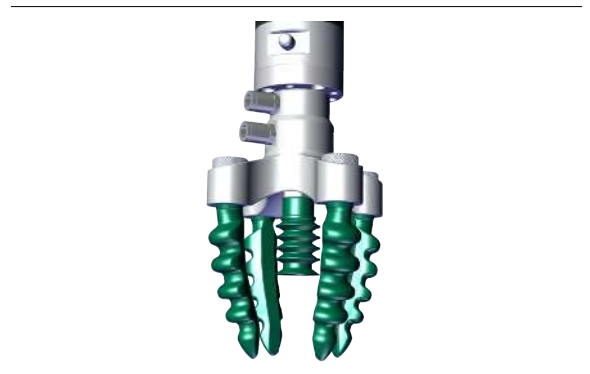

Finger Gripper OFG Combo

# Operating Instructions

**Note**

The Operating instructions were originally written in German. Store in a safe place for future reference. Subject to technical changes without notice. No responsibility is taken for printing or other types of errors.

**Published by**

© J. Schmalz GmbH, 03/21

This document is protected by copyright. J. Schmalz GmbH retains the rights established thereby. Reproduction of the contents, in full or in part, is only permitted within the limits of the legal provisions of copyright law. Any modifications to or abridgments of the document are prohibited without explicit written agreement from J. Schmalz GmbH.

**J. Schmalz GmbH** · Johannes-Schmalz-Str. 1 · 72293 Glatten, Germany · T: +49 7443 2403-0  
schmalz@schmalz.de

# Contents

<b>1 Important Information</b>	<b>4</b>
1.1 Note on Using this Document	4
1.2 The technical documentation is part of the product	4
1.3 Type Plate	4
1.4 Warnings in This Document	4
1.5 Symbol	5
<b>2 Fundamental Safety Instructions</b>	<b>6</b>
2.1 Intended Use	6
2.2 Non-Intended Use	6
2.3 Personnel Qualifications	6
2.4 Emissions	6
2.5 Overpressure	6
2.6 Modifications to the Product	7
<b>3 Product Design</b>	<b>8</b>
<b>4 Technical Data</b>	<b>9</b>
4.1 Technical Parameters	9
4.2 Dimensions	9
4.3 Gripper Alignments	10
4.4 Finger Position vs. Control Level	12
4.5 Movement Path of the Gripper Fingers	12
<b>5 Transport and Storage</b>	<b>13</b>
5.1 Checking the Delivery	13
5.2 Transport	13
5.3 Storage	13
<b>6 Description of the Function</b>	<b>14</b>
<b>7 Installation</b>	<b>15</b>
7.1 Requirements for the Higher-Level System	15
7.2 Installation Instructions	15
7.3 Mechanical Attachment	16
7.4 Pneumatic Connection	17
<b>8 Maintenance and Cleaning</b>	<b>18</b>
8.1 Maintenance Plan and Cleaning	18
8.2 Replacing or Realigning the Gripping Fingers	19
8.2.1 Removing a Gripping Finger	19
8.2.2 Fitting a Gripping Finger	20
<b>9 Warranty</b>	<b>23</b>
<b>10 Spare and Wearing Parts, Accessories</b>	<b>24</b>
<b>11 Disposing of the Device</b>	<b>25</b>

# 1 Important Information

## 1.1 Note on Using this Document

J. Schmalz GmbH is generally referred to as Schmalz in these Operating instructions.

These Operating instructions contain important notes and information about the different operating phases of the product:

- Transport, storage, start of operations and decommissioning
- Safe operation, required maintenance, rectification of any faults

The Operating instructions describe the product at the time of delivery by Schmalz.

## 1.2 The technical documentation is part of the product

1. For problem-free and safe operation, follow the instructions in the documents.
2. Keep the technical documentation in close proximity to the product. The documentation must be accessible to personnel at all times.
3. Pass on the technical documentation to subsequent users.
  - ⇒ Failure to follow the instructions in these Operating instructions may result in injuries!
  - ⇒ Schmalz is not liable for damage or malfunctions that result from failure to heed these instructions.

If you still have questions after reading the technical documentation, contact Schmalz Service at:

[www.schmalz.com/services](http://www.schmalz.com/services)

## 1.3 Type Plate

The type plate (1) is permanently attached to the product at the location shown and must always be clearly legible.

It contains important information about the product.

The type plate (1) contains the following data:

- Part number
- Part sales designation/type
- Manufacturing date
- Serial number

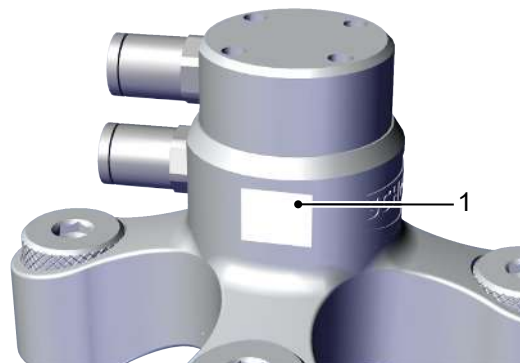

Please specify all the information above when ordering replacement parts, making warranty claims or for any other inquiries.

## 1.4 Warnings in This Document

Warnings warn against hazards that may occur when handling the product. The signal word indicates the level of danger.

Signal word	Meaning
WARNING	Indicates a medium-risk hazard that could result in death or serious injury if not avoided.
CAUTION	Indicates a low-risk hazard that could result in minor or moderate injury if not avoided.
NOTE	Indicates a danger that leads to property damage.

## 1.5 Symbol



This symbol indicates useful and important information.

- ✓ This symbol represents a prerequisite that must be met prior to an operational step.
- ▶ This symbol represents an action to be performed.
- ⇒ This symbol represents the result of an action.

Actions that consist of more than one step are numbered:

1. First action to be performed.
2. Second action to be performed.

## 2 Fundamental Safety Instructions

### 2.1 Intended Use

The finger gripper OFG combo is used for industrial transport tasks in handling processes. It is intended to be used in combination with a robot or a handling system for gripping and holding sensitive or non-rigid products (e.g. infusion bags) of the maximum specified size, including products in the logistics industry and products in secondary packaging. The sizes are dependent on the dimensions of the products and the method of gripping.

The finger gripper OFG is an incomplete machine within the meaning of the Machinery Directive 2006/42/EC. It must be operated only together with a robot or handling system.

The product is intended for industrial use.

Intended use includes observing the technical data and the installation and operating instructions in this manual.

### 2.2 Non-Intended Use

Schmalz does not accept any liability for any direct or indirect losses or damages that result from using the product. This applies, in particular, to any use of the product that is not in accordance with the intended purpose and to any use that is not described or mentioned in this documentation.

### 2.3 Personnel Qualifications

Unqualified personnel cannot recognize dangers and are therefore exposed to higher risks!

1. Task only qualified personnel to perform the tasks described in these Operating instructions.
2. The product must be operated only by persons who have undergone appropriate training.

These Operating instructions are intended for fitters who are trained in handling the product and who can operate and install it.

### 2.4 Emissions

The device emits noise due to operation with compressed air and a vacuum.



#### **⚠ CAUTION**

##### **Noise pollution caused by exhaust air or leakage during operation**

Hearing damage

- ▶ In the event of leakage, check connections and lines and remedy leakages
- ▶ Wear ear protectors.

### 2.5 Overpressure



#### **⚠ CAUTION**

##### **Risk of a gripping finger bursting if the air pressure is too high when the gripping fingers are activated.**

Risk of injury

- ▶ Ensure that the pneumatic connection is operated with a maximum air pressure of 1.6 bar.
- ▶ Wear ear plugs and protective glasses.

## **2.6 Modifications to the Product**

Schmalz assumes no liability for consequences of modifications over which it has no control:

1. The product must be operated only in its original condition as delivered.
2. Use only original spare parts from Schmalz.
3. The product must be operated only in perfect condition.

### 3 Product Design

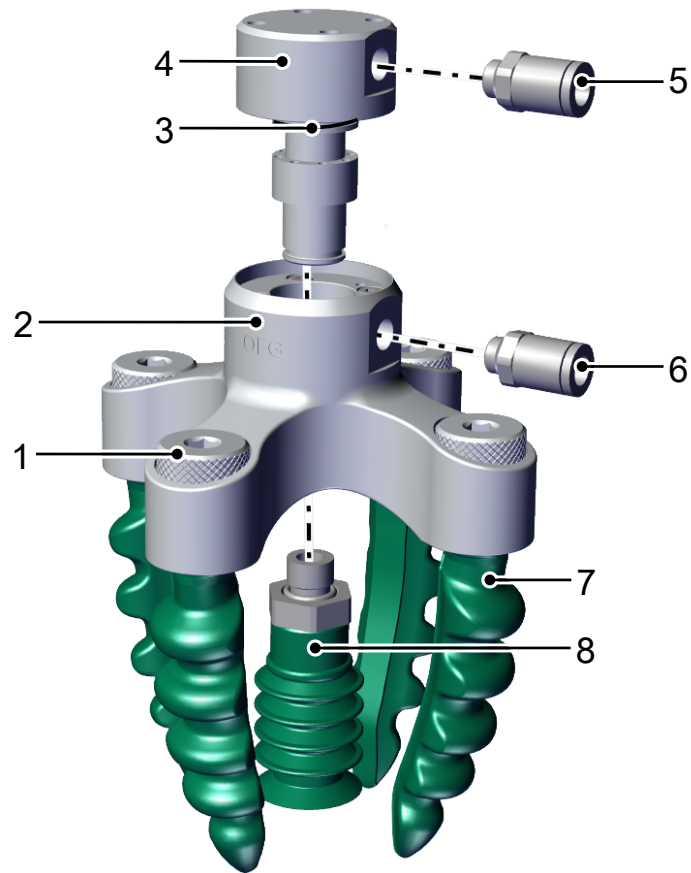

1	Cover caps with sealing ring	2	Support structure
3	Sealing ring	4	Mechanical interface with the robot/handling system
5	Pneumatic connection 1	6	Pneumatic connection 2
7	Gripping finger	8	Vacuum suction cups



## 4 Technical Data

### 4.1 Technical Parameters

Weight	612 g
Sound pressure level	Below 70 dB(A)
Pneumatic connection 1	-0.8 to 1.6 bar
Pneumatic connection 2	-0.85 to 2.0 bar
Operating medium	Compressed air, oiled or unoled in accordance with ISO 8573-1:2001, class 7-4-4
Workpiece material	All shapes and materials
Ambient temperature	Between -30 and 80° C
Maximum workpiece size	Dependent on the gripper alignment Gripper Alignments
Mass:	1 kg

### 4.2 Dimensions

d1	8
d2	8
D2	42
D3	105
H	99.3
H1	180.8
H3	43.5
Zs	20
B	26.4
Ds	31
Dr	60.5
Clamping range (Spann-ber)	265
d	5.3
D1	135
Dmk	31.5

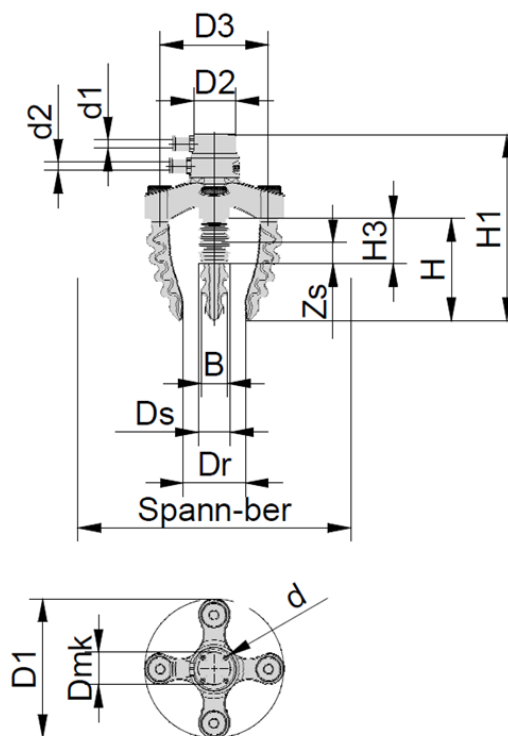

All dimensions given in millimeters [mm].

### 4.3 Gripper Alignments

Centered



Recommended for rotationally symmetrical and cuboidal products with main dimensions < 105 mm

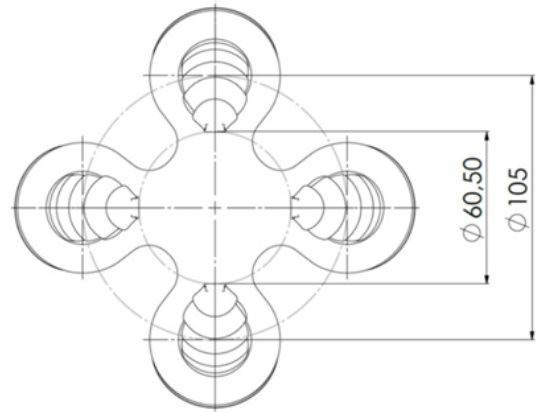
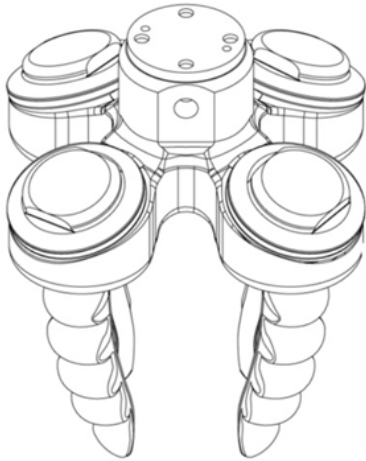
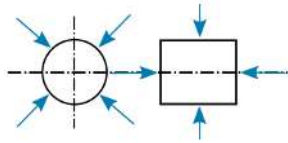

Centered out-ward



Recommended for rotationally symmetrical hollow parts with an internal diameter > 60 mm < 160 mm

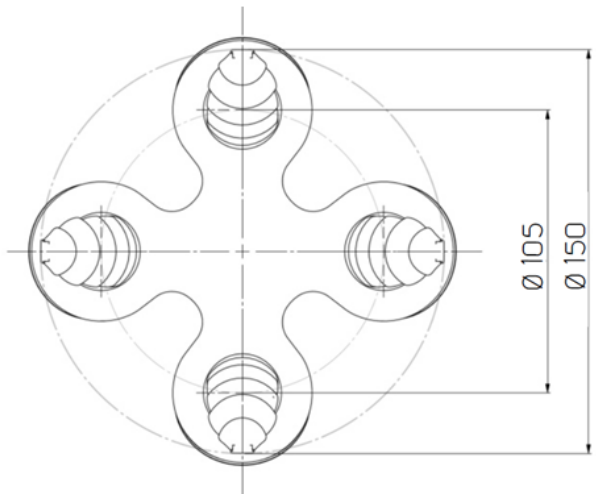
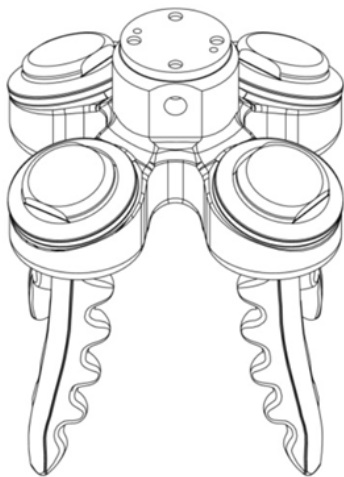

**Parallel**

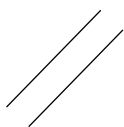

Recommended for extruded products  $L > 80$  mm

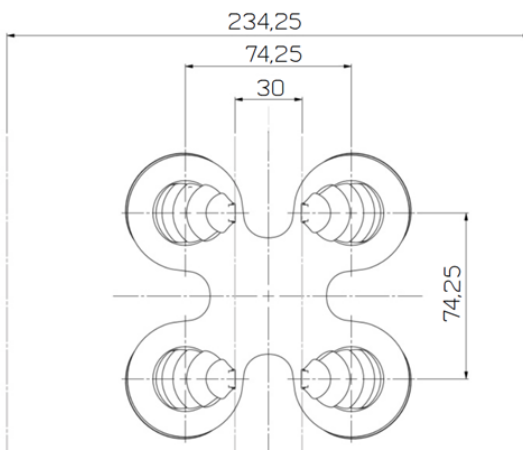
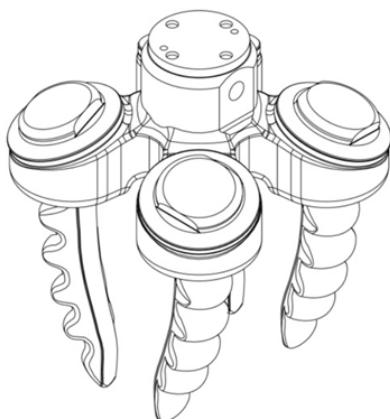
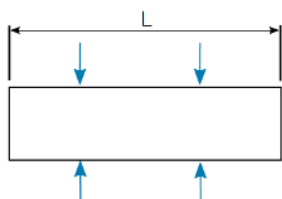

**Parallel out-ward**

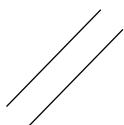

Recommended for extruded products with a cuboidal inner contour  $L > 80$  mm

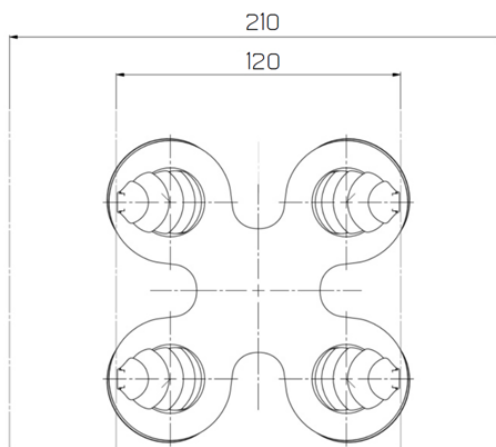
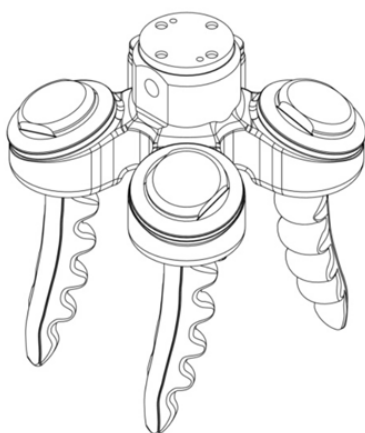
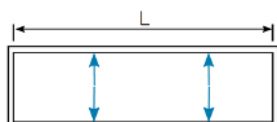

### 4.4 Finger Position vs. Control Level

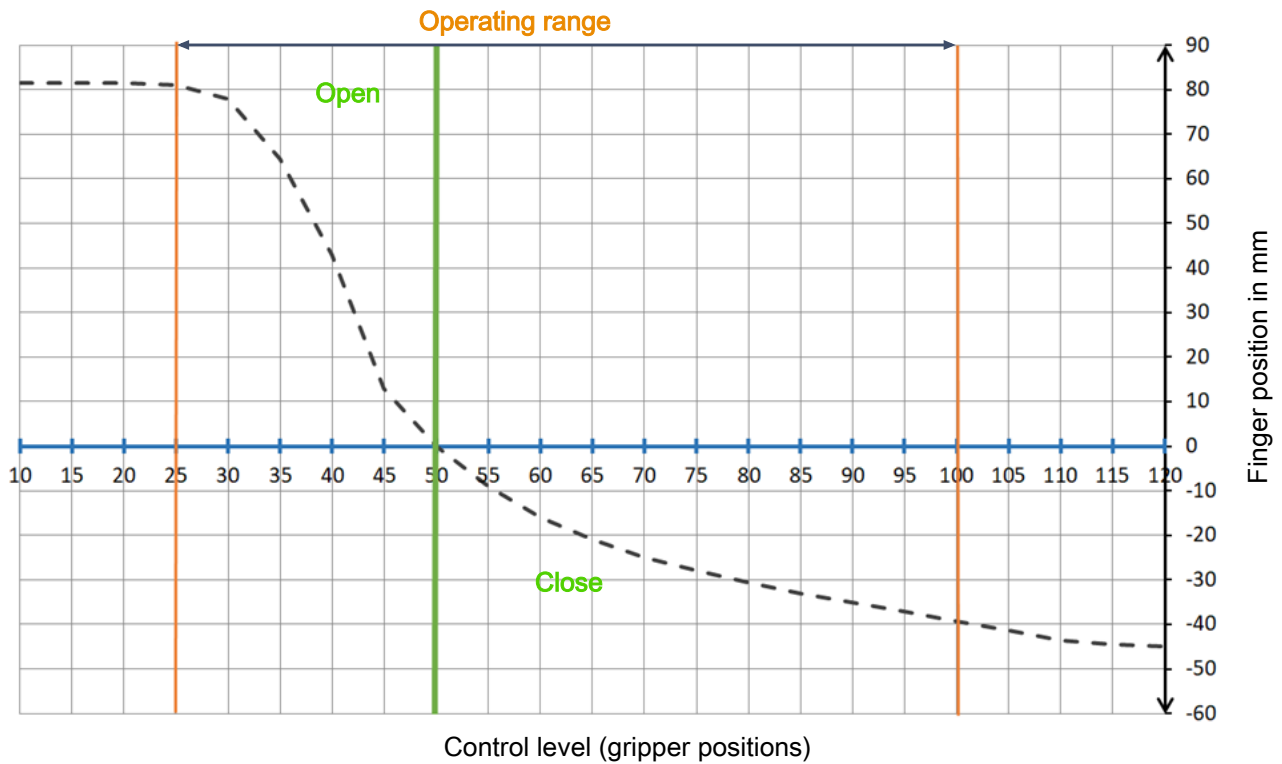

### 4.5 Movement Path of the Gripper Fingers

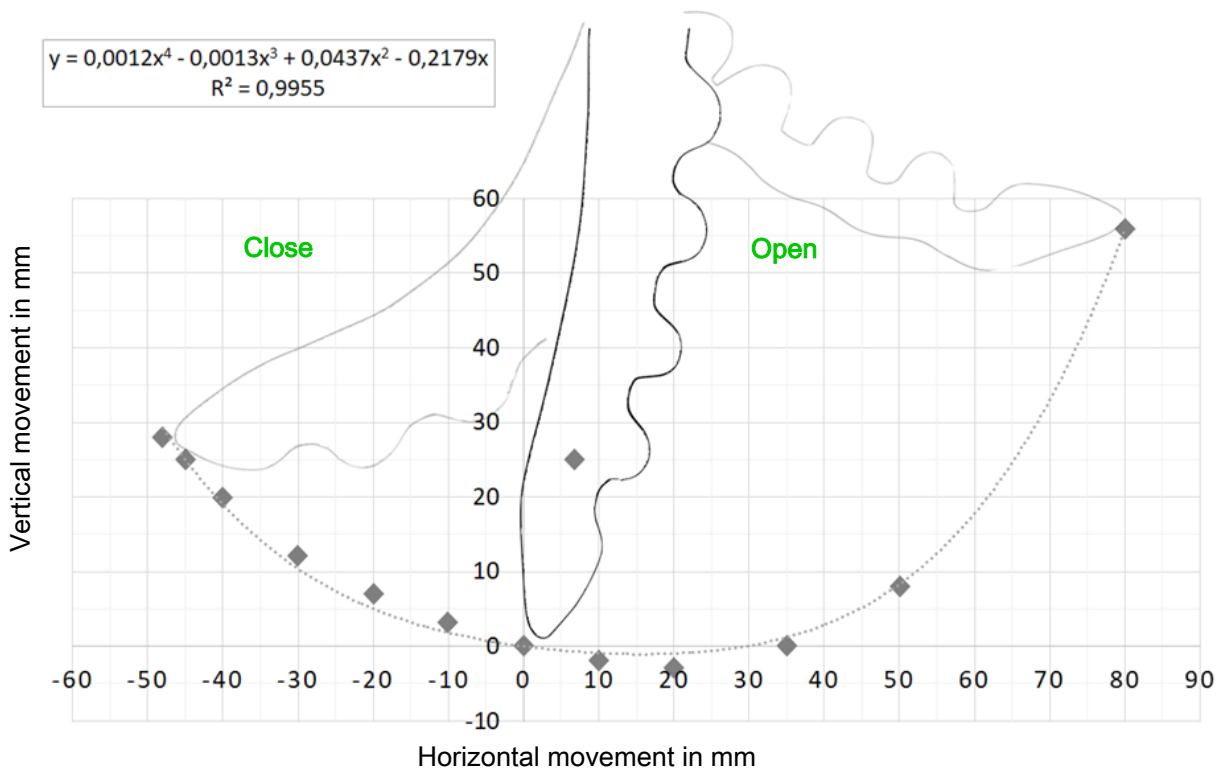

## 5 Transport and Storage

### 5.1 Checking the Delivery

The scope of delivery can be found in the order confirmation. The weights and dimensions are listed in the delivery notes.

1. Compare the entire delivery with the supplied delivery notes to make sure nothing is missing.
2. Damage caused by defective packaging or occurring in transit must be reported immediately to the carrier and J. Schmalz GmbH.

### 5.2 Transport

Flawless and dust-free containers must be used for transport to and from the installation site, and professional safety measures must be ensured.

Only means of transport that comply with the statutory provisions and the specified loads must be used.

### 5.3 Storage



#### NOTE

**The effects of ozone, light (especially UV), heat, oxygen, humidity as well as mechanical influences can reduce the service life of rubber products.**

Damage to the finger gripper due to incorrect storage!

- ▶ Store the finger gripper in a cool place (0° C to +15°C, max. 25° C) that is dark, dry, low in dust and offers protection from the weather, ozone and drafts. It should also be free of tension (e.g. stacked appropriately to avoid deformation).

- ▶ Close all openings with adhesive tape.

## 6 Description of the Function

The finger gripper works using the air pressure inside the gripping fingers. In order for the gripping fingers to move, one side of the material is designed in such a way that it is less stretchy or does not stretch at all. When the pressure inside increases, the finger therefore bends around this side. When the pressure is released, the finger retracts. The gripping fingers are made from soft, stretchy plastic to ensure optimum gripping force.

By positioning the gripping finger in its holder (in a continuously variable position), you can define the direction of bending in relation to the center of the gripper.

The centrally positioned bellows suction cup increases the holding force. It is activated and deactivated via a separate second pneumatic connection.

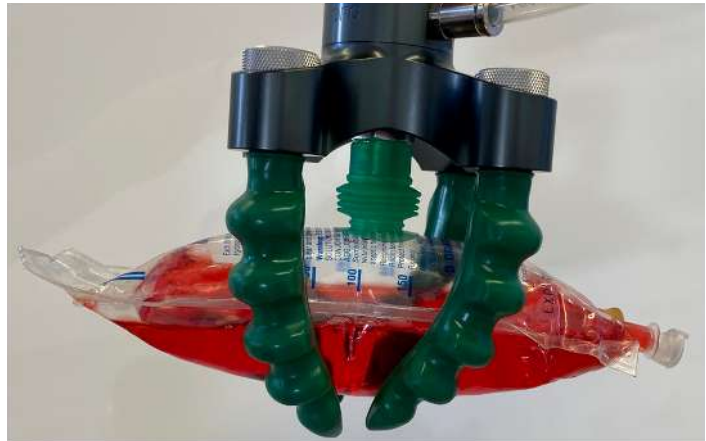

## 7 Installation

### 7.1 Requirements for the Higher-Level System

We recommend using the Schmalz controller as it is designed to work perfectly with the OFG.

The controller is used to activate and deactivate the vacuum and compressed air and thus control the "opening" and "closing" functions of the OFG:

- **Opening:** When the vacuum is activated, the gripper fingers move outward, that is, they move in the direction of the ribbed side.
- **Closing:** When the compressed air is activated, the gripper fingers move inward, that is, they move in the direction of the smooth side.

#### Gripping Control Unit – Controlled

Set opening angle and gripping force, six predefined parameters (adjustable)

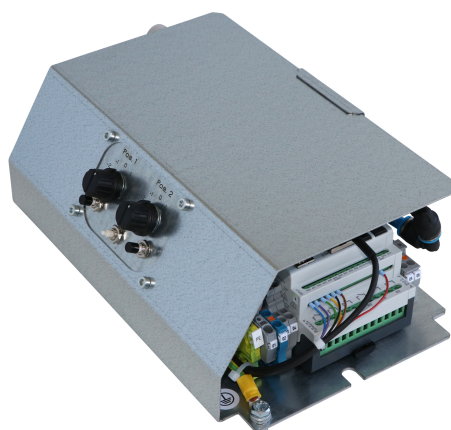

### 7.2 Installation Instructions



#### **⚠ CAUTION**

##### **Compressed air or vacuum in direct contact with the eye**

Severe eye injury

- ▶ Wear eye protection
- ▶ Do not look into compressed air openings
- ▶ Do not look into vacuum openings, e.g. suction cups



#### **⚠ CAUTION**

##### **Noise pollution caused by exhaust air or leakage during operation**

Hearing damage

- ▶ In the event of leakage, check connections and lines and remedy leakages
- ▶ Wear ear protectors.

### 7.3 Mechanical Attachment

Use only the connections, mounting holes and attachment materials that have been provided.

1. Secure the coupling flange to the manipulator/robot using 4x M5 machine screws and a tightening torque of 6 Nm (pitch diameter 31.5 mm).

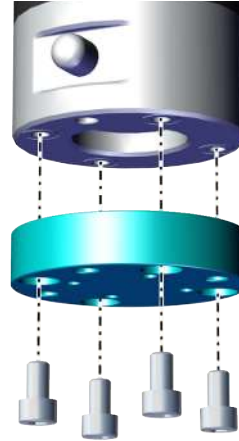

2. Attach the holder to the flange using 4x M5x30 mm machine screws.



3. Slide the gripping system over the holder using the central borehole ①. Ensure that the O-rings are fitted on the holder and the vacuum suction cup. Attach the vacuum suction cup hand-tight to the holder ②.

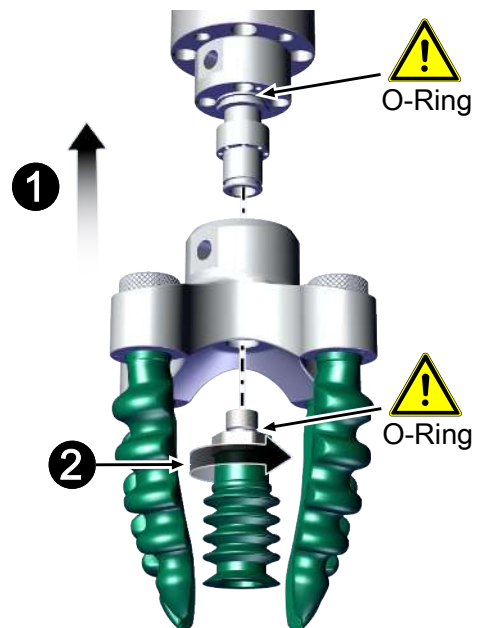



## 7.4 Pneumatic Connection

The plug-in screw unions and pneumatic hoses are fitted on the pneumatic connections (4) and (5).

- ✓ The appropriate hose (OD = 8 mm, ID = 6 mm) is ready to hand.

1. Attach the plug-in screw unions (1) to the gripping system, making sure that the O-rings are in the correct position. Tighten them all the way.

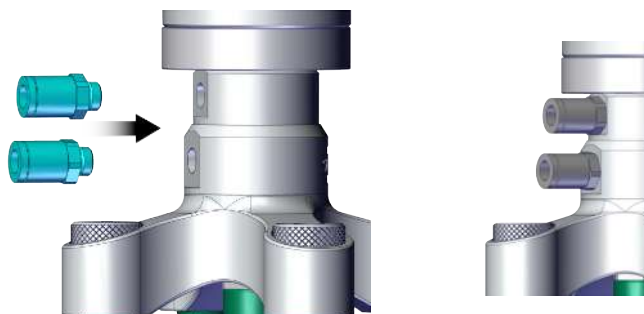

2. Push the pneumatic hoses as far as possible into the plug-in screw unions.

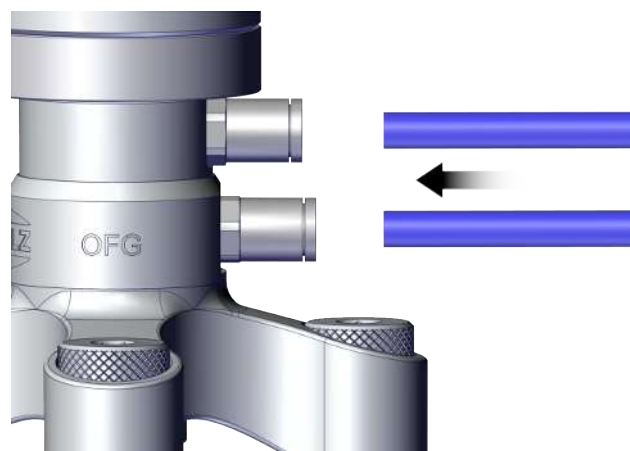

- ⇒ The pneumatic hoses fit tightly in the plug-in screw unions.

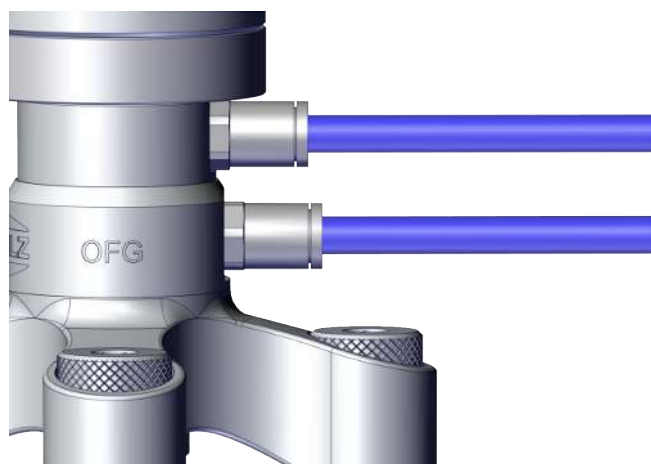

## 8 Maintenance and Cleaning

### 8.1 Maintenance Plan and Cleaning



Schmalz stipulates the following checks and check intervals. The operator must comply with the legal regulations and safety regulations applicable at the location of use. These intervals apply to single-shift operation. For heavier use, such as multi-shift operation, the intervals must be shortened accordingly.

Maintenance task	Daily	Weekly	Monthly	Every six months	Yearly
Check the supply hose and gripping fingers (vacuum/compressed air): <ul style="list-style-type: none"> <li>• Material not brittle</li> <li>• No kinks</li> <li>• Not chafed</li> <li>• Airtightness</li> </ul>			X		X
The operating instructions are available, legible, and can be accessed by personnel.					X

To safely clean the product, its materials must not react with the cleaning agent and antimicrobial chemicals (disinfectants).



#### NOTE

##### Incorrectly cleaning the product and its components

Damage to the product or individual components due to aggressive cleaning agents or excessive temperatures!

- ▶ For cleaning, use only cleaning agents that do not corrode or damage the materials used.
- ▶ Do not use sharp-edged objects (wire brushes, sandpaper, etc.).
- ▶ Do not exceed the specified max. temperature during cleaning.

The table below shows the materials used:

Component	Material
Main body	Anodized aluminum
Gripping fingers and suction cup	SI
O-rings	NBR
Screws, hose connection	Brass, nickel-plated
Flange	Aluminum

When cleaning the parts, a maximum temperature of 60° C must be observed.



The type and frequency of cleaning is the responsibility of the operating company.

## 8.2 Replacing or Realigning the Gripping Fingers

### 8.2.1 Removing a Gripping Finger

1. Remove the cover cap using a size 8 hex key (turn counterclockwise).



2. Insert a size 3 or 4 hex key into an opening on the clamping element as shown and remove/extract the clamping element with a levering motion.

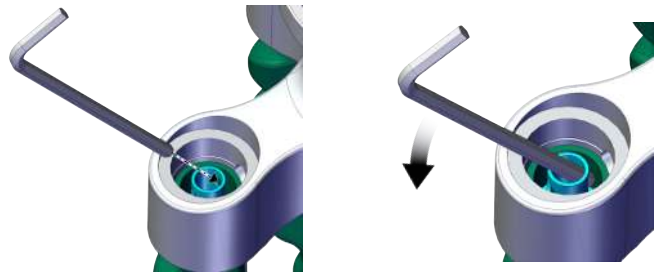

⇒ The clamping element has been removed from the opening.

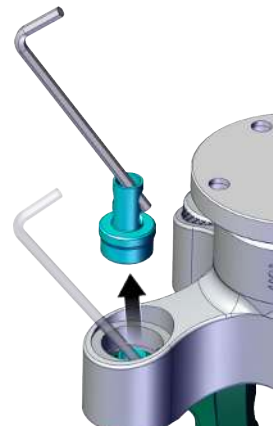

3. Remove the gripping finger from the holder in the direction shown.

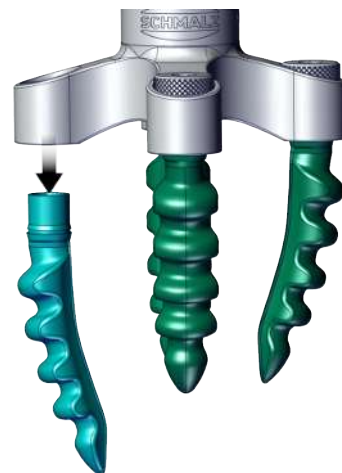

### 8.2.2 Fitting a Gripping Finger

#### Positioning the gripping fingers

By positioning the gripping finger in its holder, you can define the direction of bending in relation to the center of the gripper.

The gripping fingers can be mounted in a continuously variable position. Three markings on the underside of the gripping finger holder ① and the line formed by the tool joint on the gripping finger ② can be used for orientation.

The markings on the gripping finger holder have a spacing of 45°.

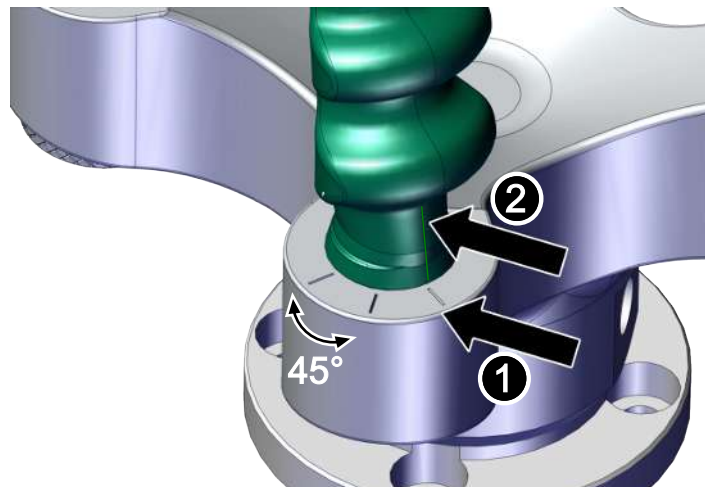

#### Reducing the friction during assembly

- i** To reduce the friction, we recommend using commercial detergent during assembly. Lightly wet the silicone surfaces and the outer surface of the clamping element with diluted detergent.

#### Fitting the gripping finger

1. Insert the gripping finger into the gripping finger holder, making sure that the ring-shaped slot on the gripping finger sits in the correct recess on the gripping finger holder.

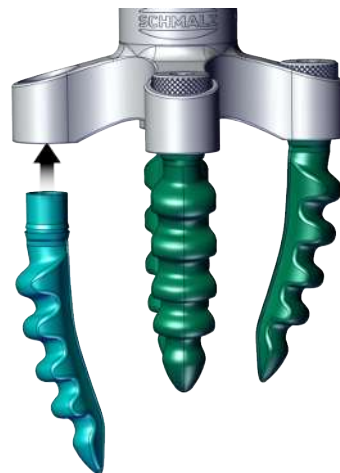

- ⇒ The slot on the gripping finger fits into the circumference of the shoulder on the gripping finger holder.

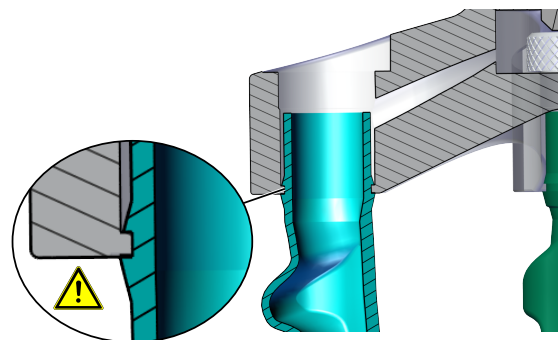

2. Use your thumb to press the clamping element into the correct position in the designated opening in the gripping finger (large diameter pointing in the direction of the gripping finger). Use your free hand to support the gripping finger so that it does not slip off of the shoulder.

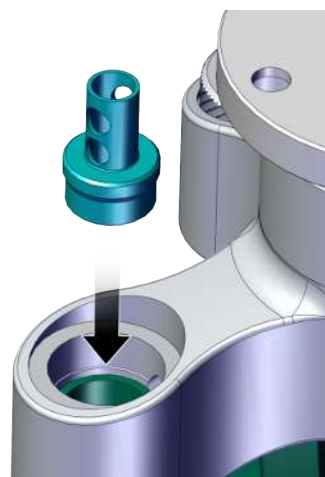

- ⇒ The clamping element is sitting precisely centered in the gripping finger opening **1**.
- ⇒ The slot on the gripping finger is fitted around the circumference of the shoulder on the holder **2**.

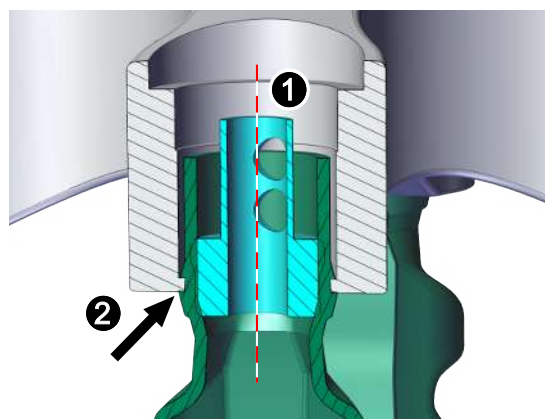

3. Turn the gripping finger in the gripping finger holder to set the desired direction of bending.

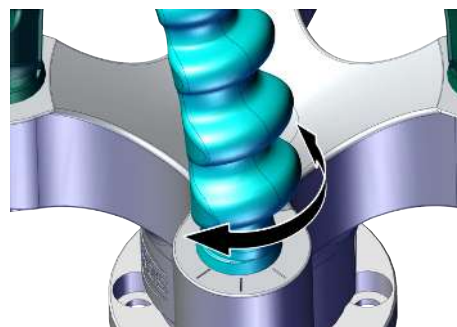

4. Screw in the cover cap as far as it will go using a size 8 hex key.  
**NOTE! O-ring not in place on the cover cap. The system is not sealed and cannot fulfill its function.**
  - ▶ Ensure that the O-ring is fitted at the position shown and is not damaged.

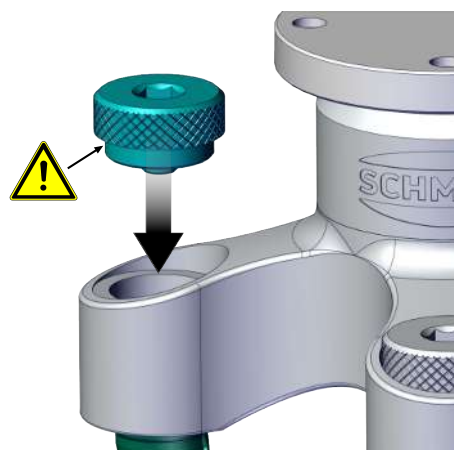

- ⇒ The cover cap is fitted correctly, meaning that:
- The O-ring seals the system ①
  - The clamping element is centered above the notches on the cover cap ②
  - The clamping element is clamped at the correct depth axially ③

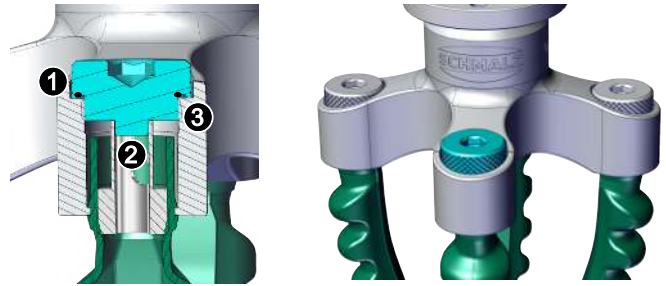

## 9 Warranty

Schmalz guarantees this system pursuant to our General Terms and Conditions of Sale and Delivery. The same applies to spare parts, provided that these are original parts supplied by us.

Wearing parts are not covered by the warranty.

## 10 Spare and Wearing Parts, Accessories

Maintenance work may only be carried out by qualified personnel.



### **⚠ WARNING**

#### **Risk of injury due to incorrect maintenance or troubleshooting**

- ▶ Check the proper functioning of the product, especially the safety features, after every maintenance or troubleshooting operation.

Designation	Part no.	Type
Wearing part set OFG (incl. bellows suction cup)	10.01.51.00014	W
Plug-in screw union, straight	10.08.02.00206	S
Plug-in screw union with swiveling angular design	10.08.02.00160	S
Pneumatic hose VSL 8-6 PU	10.07.09.00003	A
Controlled controller	10.01.51.00011	A

Legend:	S ...	Spare part
	W ...	Wearing parts
	A ...	Accessories



## 11 Disposing of the Device

1. Dispose of the product properly after replacement or decommissioning.
2. Observe the country-specific guidelines and legal obligations for waste prevention and disposal.

Component		Material/material number
Main body		Anodized aluminum
Gripping finger		SI
Suction cup	Suction cup	SI
	Nipple	Aluminum
O-ring		NBR
Screws, hose connection		Brass, nickel-plated
Machine screw		Stainless steel
Gripping finger clamping element		Aluminum
Dowel pin		1.4305
Flange and holder		Aluminum

## At your side worldwide

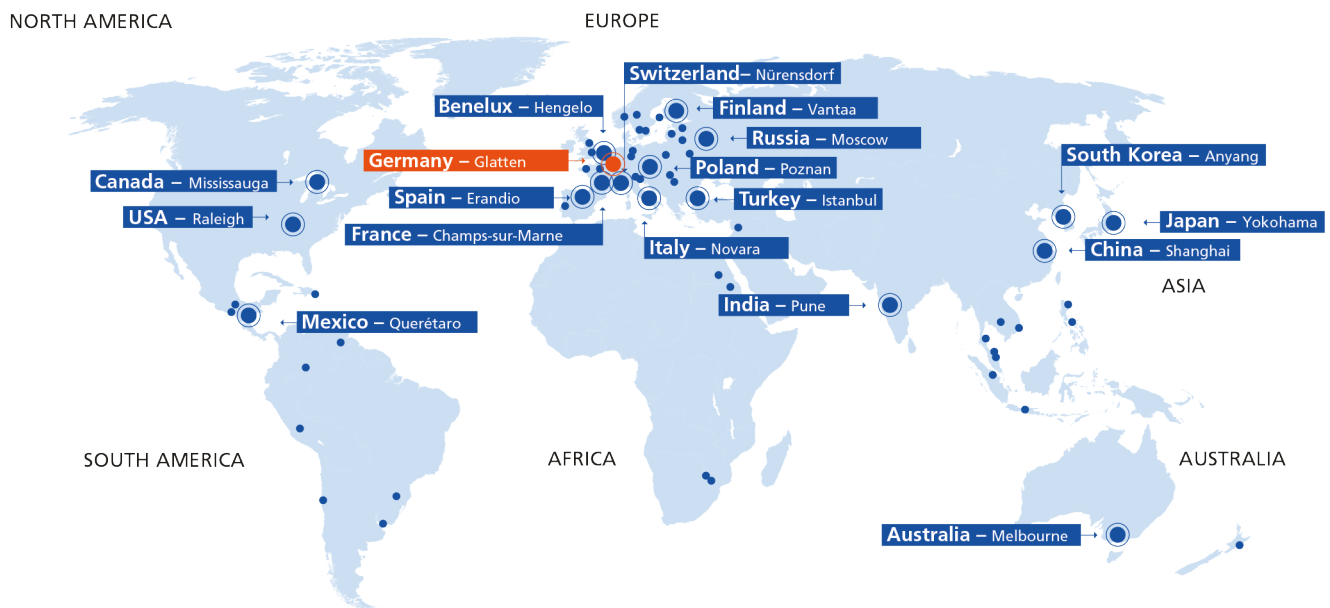

### ● Headquarters

Schmalz Germany – Glatten

### ● Sales Partners

You can find the Schmalz sales partner in your country at:  
[WWW.SCHMALZ.COM/SALESNETWORK](http://WWW.SCHMALZ.COM/SALESNETWORK)

### ● Subsidiaries

Schmalz Australia – Melbourne  
 Schmalz Benelux – Hengelo (NL)  
 Schmalz Canada – Mississauga  
 Schmalz China – Shanghai  
 Schmalz Finland – Vantaa  
 Schmalz France – Champs-sur-Marne  
 Schmalz India – Pune  
 Schmalz Italy – Novara  
 Schmalz Japan – Yokohama

Schmalz Mexico – Querétaro  
 Schmalz Poland – Suchy Las (Poznan)  
 Schmalz Russia – Moscow  
 Schmalz South Korea – Anyang  
 Schmalz Spain – Erandio (Vizcaya)  
 Schmalz Switzerland – Nürens Dorf  
 Schmalz Turkey – Istanbul

## Vacuum Automation

[WWW.SCHMALZ.COM/AUTOMATION](http://WWW.SCHMALZ.COM/AUTOMATION)

## Handling Systems

[WWW.SCHMALZ.COM/HANDLINGSYSTEMS](http://WWW.SCHMALZ.COM/HANDLINGSYSTEMS)

J. Schmalz GmbH  
 Johannes-Schmalz-Str. 1  
 72293 Glatten, Germany  
 T: +49 7443 2403-0  
 schmalz@schmalz.de  
 WWW.SCHMALZ.COM