

Chocolate Suction Cups SPG

Suction area (Ø) 33 mm



Suitability for Industry Specific Applications

Applications

- Bell-shaped suction cup for dynamic handling and packing of chocolates in combination with picker robots
- Direct handling of round, oval or square chocolates
- Handling of confectionery with structured surfaces or toppings
- Suitable for direct contact with food due to FDA compliant material silicone
- Handling of round chocolates with maximum diameter of 35 mm and oval / square chocolates with maximum diagonal measurement of 30 mm



Chocolate Suction Cups SPG

Design

- Suction cup (1) with extremely thin, soft sealing lip and tapered suction cup geometry
- Optimal sealing lip shape for handling workpieces with structured surfaces
- Use of one-piece insertable connection element (2), with G1/8" male or female thread, for changing the suction cup quickly
- Connection element with male thread has an integrated seal

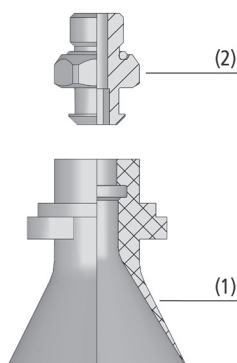

System Design Chocolate Suction Cups SPG



Chocolate suction cups SPG being used for handling chocolates

Our Highlights...

- Extremely thin sealing lip
- Tapered sealing lip shape
- Large nominal flow
- FDA compliant material silicone

Your Benefits...

- Good sealing on decorated chocolates
- Even square chocolates are enclosed by suction cup; dynamic handling possible
- Leakage compensation on highly-structured chocolates
- Suitable for direct contact with food

Schmalz – The Company

Vacuum Suction Cups

Special Grippers

Gripping Systems

Clamping Systems

Mounting Elements

Vacuum Generators

Valve Technology

Switches and Monitoring

Filters and Connections

Services

Contact

Glossary

Index of Products



Chocolate Suction Cups SPG

Suction area (Ø) 33 mm



Designation Code Chocolate Suction Cups SPG

SPG	-	33	-	SI-45	-	SC040
1		2		3		4

1 – Abbreviated designation

Code	Version
SPG	Bell-shaped

2 – Suction area

Code	Diameter in mm
33	ø 33

3 – Material

Code	Material
SI-45	Silicone
SI-HD	Silicone

4 – Connection

Code	Connection
SC040	SC040

Chocolate suction cup SPG (elastomer part) is supplied as an individual part.

In order to receive a complete suction cup (elastomer part + connection element), the following ordering steps are required:

- Suction cup of type SPG – elastomer part
- Connection element of type SC – available with various threads



Ordering Data Chocolate Suction Cups SPG

Type*	Part no.
SPG 33 SI-45 SC040	10.01.19.00002
SPG 33 SI-HD SC040	10.01.19.00165

*Additional material specifications at beginning of the section "Vacuum Suction Cups"



Ordering Data Accessories Chocolate Suction Cups SPG

SC 040 G1/8-AG	SC 040 G1/8-IG
10.01.06.02490	10.01.06.02482



Technical Data Chocolate Suction Cups SPG

Type	Volume [cm³]	Hose diameter (recom.) d [mm]*	Nipple family
SPG 33 SI-45 SC040	8.1	4	SC 040
SPG 33 SI-HD SC040	8.1	4	SC 040

*The suction force and operating vacuum are dependent on the geometry and surface characteristics of the chocolate. We recommend a maximum operating vacuum of -150 mbar.

Chocolate Suction Cups SPG

Suction area (Ø) 33 mm



Design Data Chocolate Suction Cups SPG

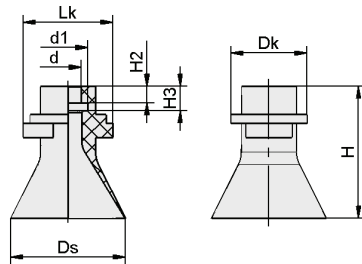

SPG

Type*	d [mm]	d1 [mm]	Dk [mm]	Ds [mm]	H [mm]	H2 [mm]	H3 [mm]	Lk [mm]
SPG 33 SI-45 SC040	7.3	11	21.5	32.1	38	4.8	7	25.5
SPG 33 SI-HD SC040	7.3	11	21.5	32.1	38	4.8	7	25.5

*Acceptable dimensional tolerances for rubber parts concerning to DIN ISO 3302-1 M3

- Schmalz – The Company
- Vacuum Suction Cups
- Special Grippers
- Gripping Systems
- Clamping Systems
- Mounting Elements
- Vacuum Generators
- Valve Technology
- Switches and Monitoring
- Filters and Connections
- Services
- Contact
- Glossary
- Index of Products

