

Solenoid Valves EMVO

Nominal diameter from 12 mm to 25 mm



Suitability for Industry Specific Applications



Applications

- Solenoid valve for use at high volume flow rates in systems with large cross sections
- Control of vacuum and venting of the suction cup
- Suitable for neutral or filtered air

Solenoid Valves EMVO

Design

- Directly controlled solenoid valve
- Switching function (NC)
- Seat valve in housing made of brass and aluminum
- Degree of protection IP 65
- Connection socket complies with DIN 43 650, Form A
- Supplied complete with plug connector

Product Highlights

- 3/2 multiway valve for controlling vacuum on/off or ventilation
- Valve suitable for large nominal flows
- Direct control enables fastest opening and closing times

Designation Code Solenoid Valves EMVO

| | | | | | | | | |
|-------------|---|-----------|---|----------------|---|------------|---|-----------|
| EMVO | - | 12 | - | 230V-AC | - | 3/2 | - | NC |
| 1 | | 2 | | 3 | | 4 | | 5 |

1 – Abbreviated designation

| Code | Version |
|------|---------|
| EMVO | EMVO |

2 – Nozzle size

| Code | Nozzle size in mm |
|---------|-------------------|
| 12...25 | 12 to 25 |

3 – Voltage

| Code | Voltage in V |
|---------|----------------|
| 24V-DC | Direct current |
| 230V-AC | Single phase |

4 – Variant

| Code | Type |
|------|---------------|
| 3/2 | 3/2-way valve |

5 – Idle position suction valve

| Code | Type |
|------|-----------------|
| NC | Normally closed |
| NO | Normally open |

Solenoid valve EMVO is delivered as a ready-to-connect product.

Available accessories: venting filter

Solenoid Valves EMVO

Nominal diameter from 12 mm to 25 mm

Ordering Data Solenoid Valves EMVO

| Type | Part no. |
|------------------------|----------------|
| EMVO 12 230V-AC 3/2 NC | 10.05.01.00052 |
| EMVO 12 24V-DC 3/2 NC | 10.05.01.00049 |
| EMVO 20 230V-AC 3/2 NC | 10.05.01.00053 |
| EMVO 20 24V-DC 3/2 NC | 10.05.01.00050 |
| EMVO 25 24V-DC 3/2 NC | 10.05.01.00051 |

Ordering Data Accessories Solenoid Valves EMVO

| Type | Accessories | Part no. |
|------------------------|-------------------------------------|----------------|
| EMVO 12 230V-AC 3/2 NC | Venting filter FAS 80x33.8 G1/2-AG | 10.05.01.00061 |
| EMVO 12 24V-DC 3/2 NC | Venting filter FAS 80x33.8 G1/2-AG | 10.05.01.00061 |
| EMVO 20 230V-AC 3/2 NC | Venting filter FAS 80x39 G3/4-AG | 10.05.01.00062 |
| EMVO 20 24V-DC 3/2 NC | Venting filter FAS 80x39 G3/4-AG | 10.05.01.00062 |
| EMVO 25 24V-DC 3/2 NC | Venting filter FAS 80x38 G1-AG EMVP | 10.05.01.00063 |

Technical Data Solenoid Valves EMVO

| Type | Control valve | Nominal flow rate [m³/h] | Nominal flow rate [l/min] | Power consumption DC [W] | Power consumption AC [W] | Weight [kg] |
|------------------------|-----------------|--------------------------|---------------------------|--------------------------|--------------------------|-------------|
| EMVO 12 230V-AC 3/2 NC | Normally closed | 21 | 350 | - | 39.1 | 1.2 |
| EMVO 12 24V-DC 3/2 NC | Normally closed | 21 | 350 | 31.9 | - | 1.2 |
| EMVO 20 230V-AC 3/2 NC | Normally closed | 72 | 1,200 | - | 36.8 | 5.8 |
| EMVO 20 24V-DC 3/2 NC | Normally closed | 72 | 1,200 | 40.8 | - | 5.8 |
| EMVO 25 24V-DC 3/2 NC | Normally closed | 101 | 1,684 | 40.8 | - | 5.7 |

Solenoid Valves EMVO

Nominal diameter from 12 mm to 25 mm

Design Data Solenoid Valves EMVO

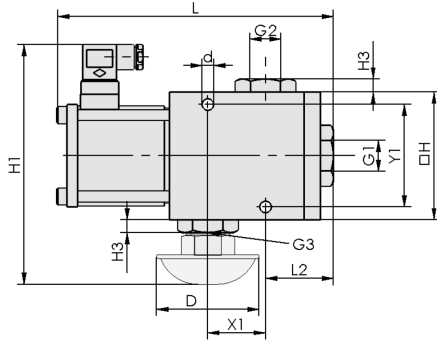

EMVO

Solenoid Valves EMVO

Nominal diameter from 12 mm to 25 mm

Design Data Solenoid Valves EMVO

| Type | d [mm] | D [mm] | G1 | G2 | G3 | H [mm] | H1 [mm] | H3 [mm] | L [mm] | L2 [mm] | X1 [mm] | Y1 [mm] |
|------------------------------|--------|--------|---------|---------|---------|--------|---------|---------|--------|---------|---------|---------|
| EMVO 12 230V-AC 3/2 NC | 6.5 | 80 | G1/2"-F | G1/2"-F | G1/2"-F | 60 | 135.5 | - | 122 | 32 | 24 | 40 |
| EMVO 12 24V-DC 3/2 NC | 6.5 | 80 | G1/2"-F | G1/2"-F | G1/2"-F | 60 | 135.5 | - | 122 | 32 | 24 | 40 |
| EMVO 20 230V-AC 3/2 NC | 9.0 | 80 | G3/4"-F | G3/4"-F | G3/4"-F | 100 | 187.5 | 10 | 206 | 43 | 45 | 80 |
| EMVO 20 24V-DC 3/2 NC | 9.0 | 80 | G3/4"-F | G3/4"-F | G3/4"-F | 100 | 187.5 | 10 | 206 | 43 | 45 | 80 |
| EMVO 25 24V-DC 3/2 NC | 9.0 | 80 | G1"-F | G1"-F | G1"-F | 100 | 172.0 | - | 206 | 43 | 45 | 80 |